

# Constructing the world's highest capacity safe haven

Gregor Gregersen, director and founder

The Reserve Pte Ltd

7 June 2022



**The Reserve**

# Why vaults, why now

## The Continental Dollar

Gold Backing Value		1775	1776	1777	1778	1779	1780
~12 Million Continentals	Deficit (in millions)	6	19	13	64	125	<b>Printing ceased</b>
	US Deficit % of gold reserves	150%	308%	417%	950%	1992%	<b>Loss of faith</b>

## The United Stated Dollar

Gold Backing Value		2017	2018	2019	2020	2021	....
~500 Billion USD*	Deficit (in millions USD)	671,456	1,271,158	1,203,343	4,225,990	1,483,527	
	Debt (in millions USD)	20,244,900	21,516,058	22,719,401	26,945,391	28,428,918	
	<b>Deficit % of gold reserves</b>	<b>134%</b>	<b>254%</b>	<b>241%</b>	<b>845%</b>	<b>297%</b>	
	<b>Debt % of gold reserves</b>	<b>4049%</b>	<b>4303%</b>	<b>4544%</b>	<b>5389%</b>	<b>5686%</b>	
	<b>Including unfunded liabilities</b>	<b>13049%</b>	<b>13303%</b>	<b>13544%</b>	<b>14389%</b>	<b>14686%</b>	

\*8133 tons at around ~1900 USD per oz



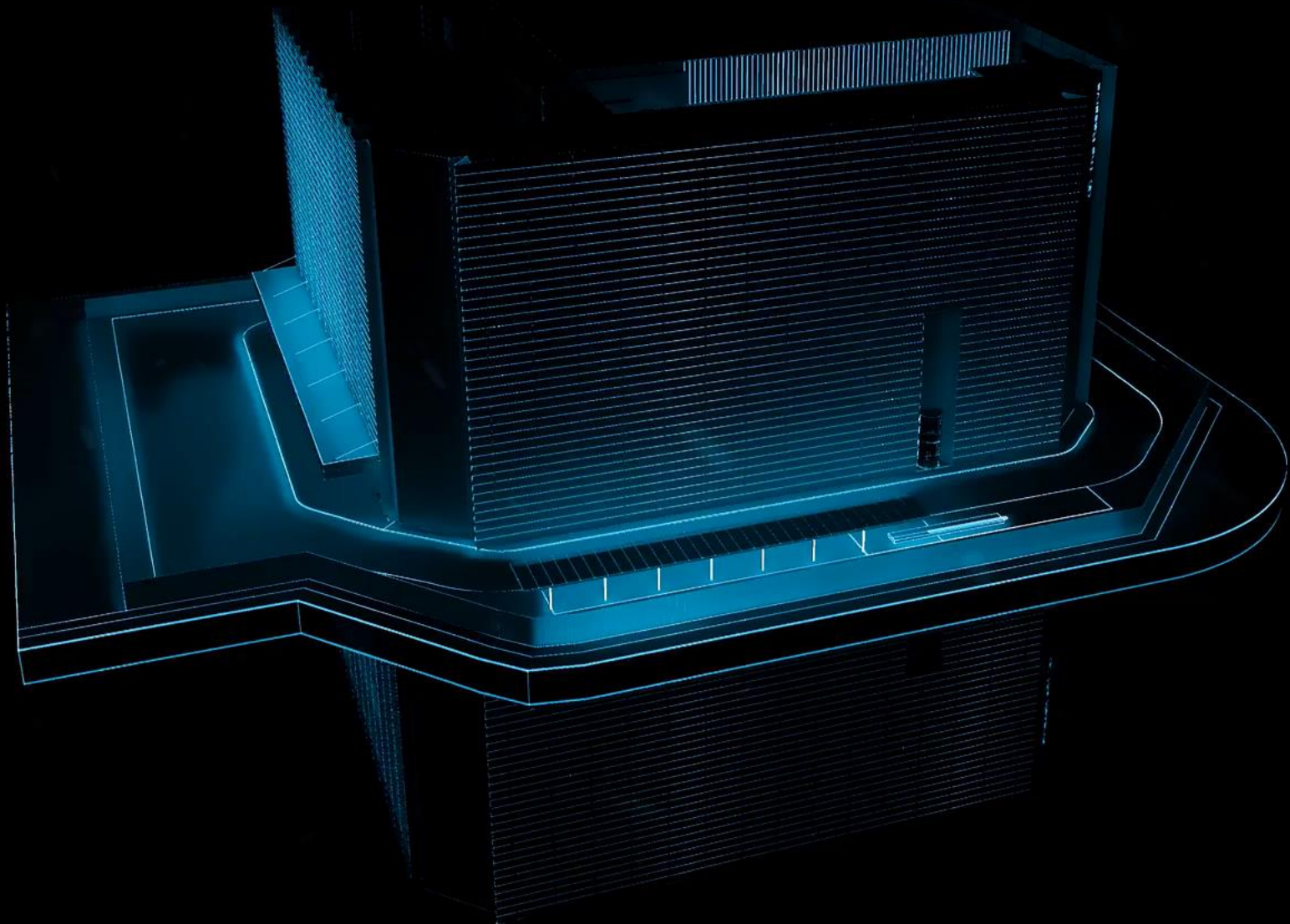



**Floor 1 – Bulk and high value storage**  
**Floor 2 – Bulk and segregated art storage**  
**Floor 3 – Bulk storage**  
**Floor 4 – Services, watch atelier, SDBs**  
**Floor 5 – Offices, lounges, meeting rooms**  
**Floor 6 – Support**





6-7 June 2022

InterContinental Singapore

## High Efficiency Bulk Vaulting:

- 28,000 sqft for lease
- High floor loading and ceilings
- Ideal for silver / rare metals

## Supporting Infrastructure

- Testing lab (TSH)
- Collateralizable
- GramChain / Chainlink digitizable



Bulk Vaulting



6-7 June 2022

InterContinental Singapore

## **Segregated Art Vaults:**

- 12,000 sqft across 12+ vaults
- Nitrogen fire suppression systems
- Regulated temperature / humidity

## **Supporting Infrastructure**

- Photo / video studio
- Private viewing gallery
- Zoned for auctions (URA)
- GramChain / Chainlink digitizable



Segregated Art Vaults

6-7 June 2022

InterContinental Singapore

## **UL class 2 modular vaults:**

- 14 vaults for lease
- Lowers insurance premiums
- Ideal for storage of up to 800 million SGD each

## **Optional Supporting Services**

- Staff / bonded / liability protection
- Testing lab (TSH)
- Collateralizable
- GramChain/Chainlink digitizable



# **High Value Vaulting**



## Lounges and offices

---

- Ancillary office space for lease
- Member meeting rooms
- Member events / barista
- Watch atelier / authentication
- 12,500 safe deposit boxes
- Collateralization & digitalization

# Authentication & Tracking

of physical assets, with replacement guarantee

Hybrid  
**ASIA PACIFIC**  
**PRECIOUS METALS**  
CONFERENCE

6-7 June 2022

InterContinental Singapore



## Testing Labs authenticate via:

- X-ray Spectrography
- Ultrasound measurements
- Electrical Conductivity
- Density
- Magnetism



## Watch Atelier forensic authentication:

- Brand collaboration
- Highly experienced watch makers
- X-ray Spectrography
- Internal / part inspection
- Others...

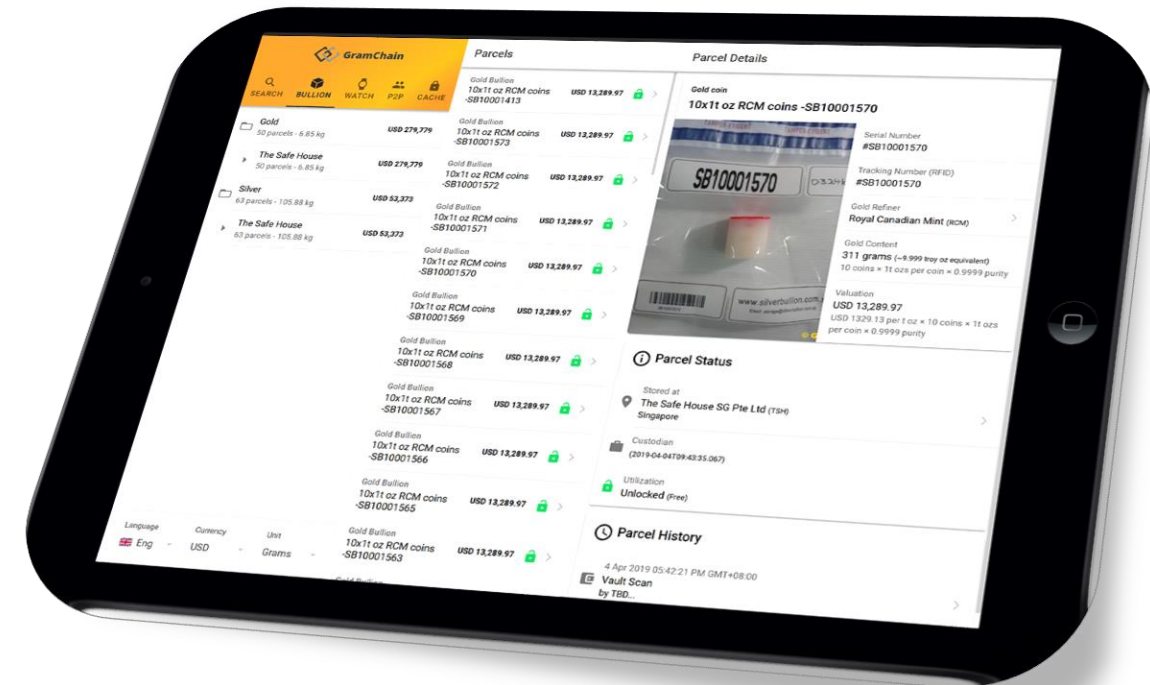

Tamper evident tracking via GramChain



# Digitization

of physical assets in real time

Hybrid  
**ASIA PACIFIC**  
**PRECIOUS METALS**  
CONFERENCE

6-7 June 2022

InterContinental Singapore

RFID Scanner(s)



Linked  
Tablets



RFID Tags



Bullion  
ECM  
(Tester)

Tamper  
Evident Bags



**Physical**  
Deployments:

Singapore  
Zurich  
Dallas  
Dubai  
Frankfurt



**Digital**

Public blockchains:

Backed Tokens  
Backed NFTs





# Collateralization

of physical assets

6-7 June 2022

InterContinental Singapore

## Collateralized Loans

- 400 Million SGD collateralized since 2015
- 132 Million SGD annually growing at 62%
- Average loan interest at ~4% p.a.

## Collateralizable Assets

- Gold, silver, platinum, palladium, nickel
- Luxury watches (coming soon)
- More assets expected in 2023

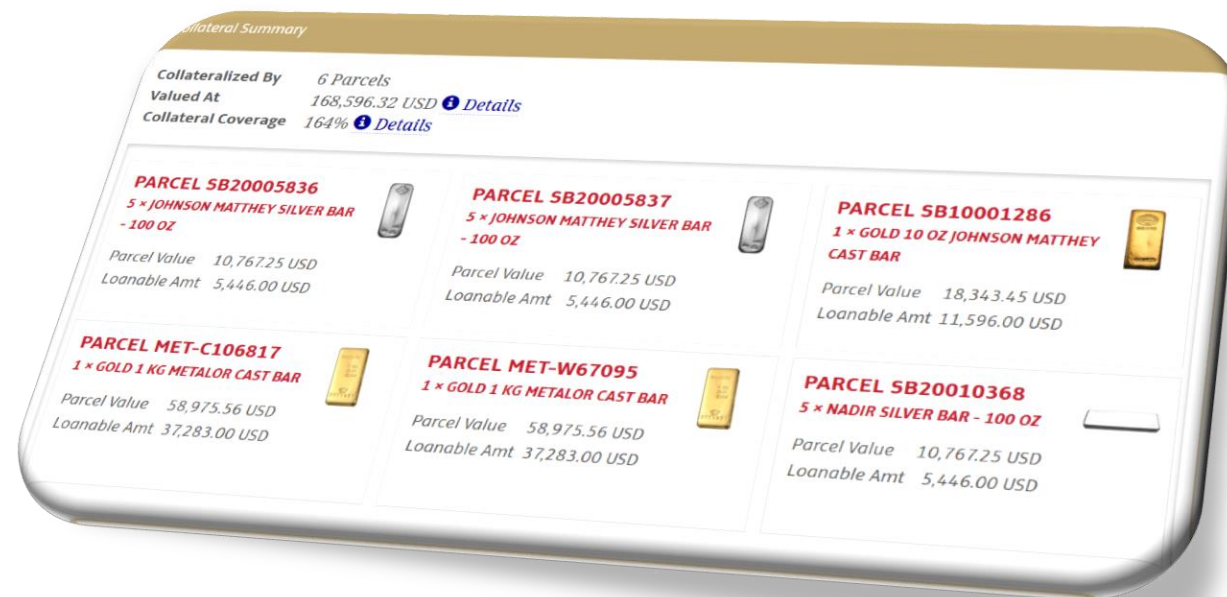

Collateral Summary	
Collateralized By	6 Parcels
Valued At	168,596.32 USD <a href="#">Details</a>
Collateral Coverage	164% <a href="#">Details</a>
<b>PARCEL SB20005836</b> 5 x JOHNSON MATTHEY SILVER BAR - 100 OZ	<b>PARCEL SB20005837</b> 5 x JOHNSON MATTHEY SILVER BAR - 100 OZ
Parcel Value 10,767.25 USD Loanable Amt 5,446.00 USD	Parcel Value 10,767.25 USD Loanable Amt 5,446.00 USD
<b>PARCEL MET-C106817</b> 1 x GOLD 1 KG METALOR CAST BAR	<b>PARCEL MET-W67095</b> 1 x GOLD 1 KG METALOR CAST BAR
Parcel Value 58,975.56 USD Loanable Amt 37,283.00 USD	Parcel Value 58,975.56 USD Loanable Amt 37,283.00 USD
<b>PARCEL SB10001286</b> 1 x GOLD 10 OZ JOHNSON MATTHEY CAST BAR	<b>PARCEL SB20010368</b> 5 x NADIR SILVER BAR - 100 OZ
Parcel Value 18,343.45 USD Loanable Amt 11,596.00 USD	Parcel Value 10,767.25 USD Loanable Amt 5,446.00 USD



# The Reserve

**To be completed  
by early to mid 2023**



<https://thereserve.sg/>